



A Project by Amayra Group..





PBRERA-SAS80-PR1219  
www.rera.punjab.gov.in



+91 9023110005

info@amayragroup.in

www.amayragroup.in

Site Address : Chandigarh-Manali Highway, NH205, Kharar, Greater Mohali. | Corporate Office : SCO 26-29, Amayra City Centre Chandigarh-Ropar Road, NH-205, Kharar, Greater Mohali. | FOLLOW US ON :    

EXQUISITE RESIDENTIAL TOWNSHIP



## A LEGACY OF BUILDING ASPIRATIONS, and setting new standards in realty sector.

Over the last 12 years, Amayra has built residential, commercial and retail projects that are today a testimony for impeccable architectural standards. Fulfilling the aspirations of numerous home buyers and business owners ensuring the timely delivery of their dream homes & commercial, Amayra Group has become synonymous with trust & quality construction. And this is the achievement the company takes most pride in.

Amayra is today amongst the top developers in Punjab. A credo of uncompromising values, customer centricity, robust engineering, and transparent business operations, has earned Amayra many accolades from customers and the public at large. Amayra is also popular for it's unique conceptualizing sensibilities.

12\*

YEARS  
OF  
LEGACY

03\*

THOUSAND  
HAPPY  
FAMILIES

11\*

LANDMARK  
PROJECTS  
ONGOING &  
DELIVERED

05\*

MILLION  
SQUARE FEET  
OF DEVELOPED  
AREA

05\*

MILLION  
SQ. FEET  
AREA UNDER  
DEVELOPMENT

20\*

PLUS AWARDS  
& ACCOLADES

AMAYRA  
SKYCITY

Exquisite Residential Township

1, 2, 3, 3+1 BHK RESIDENCIES & PENTHOUSES

It is an ultra-modern, bold and luxurious residential project.  
SKILFULLY CRAFTED BY A GLOBALLY ACCLAIMED ARCHITECT

AN ICON OF EXCELLENCE  
MUCH MORE THAN A LANDMARK



Artist's Impression

Disclaimer- This advertisement does not constitute an offer and/or acceptance and/or contract and/or agreement and/or transaction and/or any intention thereof and/or a disclosure under any statute of any nature whatsoever. The photograph contained herein has been modified, and/or enhanced, and/or touched up/airbrushed for display and marketing purposes. No representation or warranty is made or intended as to the accuracy or completeness of information under this advertisement/promotional document or as to its suitability or adequacy for any purpose. Before making a decision to purchase, you are requested to independently, either directly or through your legal/financial consultants, thoroughly verify all details/documents pertaining to this project as available on <https://punjab.rera.gov.in>

A RERA Registration No. PBRERA-SAS80-PR1219  
View details at <https://punjab.rera.gov.in>

AMAYRA  
SKYCITY

Exquisite Residential Township

## SETTING NEW STANDARDS IN URBAN LIVING for an enviable lifestyle and wellbeing.

As cities grow, the simple joys of life—a quiet walk, fresh air, and open green spaces—seem to retreat. At Amayra SkyCity, they return as part of your everyday lifestyle. Located in the heart of Greater Mohali, this landmark township blends elegant high-rises, lush landscapes, and seamless connectivity to create a rare urban sanctuary. Designed with precision and care, it offers spacious residences, select sky-deck apartments, and a world of premium amenities that celebrate your success.

Amayra SkyCity isn't just an address; it's where comfort, elegance, and legacy meet.



## ICONIC FACADE ENTRANCE

Artist's Impression

Disclaimer- This advertisement does not constitute an offer and/or acceptance and/or contract and/or agreement and/or transaction and/or any intention thereof and/or a disclosure under any statute of any nature whatsoever. The photograph contained herein has been modified, and/or enhanced, and/or touched up/airbrushed for display and marketing purposes. No representation or warranty is made or intended as to the accuracy or completeness of information under this advertisement/promotional document or as to its suitability or adequacy for any purpose. Before making a decision to purchase, you are requested to independently, either directly or through your legal/financial consultants, thoroughly verify all details/documents pertaining to this project as available on <https://punjab.rera.gov.in>

A RERA Registration No. PBRERA-SAS80-PR1219  
View details at <https://punjab.rera.gov.in>



SITE PLAN

COMPRISES 16 ICONIC TOWERS SPREAD OVER 10 ACRES



Artist's Impression

Disclaimer- This advertisement does not constitute an offer and/or acceptance and/or contract and/or agreement and/or transaction and/or any disclosure thereof and/or a disclosure under any statute of any nature whatsoever. The photograph contained herein has been modified, and/or enhanced, and/or touched up/airbrushed for display and marketing purposes. No representation or warranty is made or intended as to the accuracy or completeness of information under this advertisement/promotional document or as to its suitability or adequacy for any purpose. Before making a decision to purchase, you are requested to independently, either directly or through your legal/financial consultants, thoroughly verify all details/documents pertaining to this project as available on <https://punjab.rera.gov.in>

A RERA Registration No. PBRERA-SAS80-PR1219  
View details at <https://punjab.rera.gov.in>



## 4 ASPECTS

that makes it A SIGNATURE project of the Greater Mohali



Unmatched  
**CONNECTIVITY**  
all your long commutes  
will become shorter.



Grand  
**ENTRANCE**  
The grandeur of timeless  
elegance..



Exquisite  
**INDOOR & OUTDOOR**  
Features for premium lifestyle..



Exclusive  
**CLUB HOUSE**  
Much more than a privilege..

# THE LESSER THE DISTANCE, THE BETTER YOUR ACCESS.

-  Immediate access to NH-205 and near to GMADA Expressway..
-  International schools like Cambridge, Vidya valley, Skonis and St. Ezra close by..
-  Max Hospital, ClearMedi Multi Speciality Hospital in close vicinity.
-  The best Colleges and Universities of Mohali just a short drive away
-  IT City Mohali-Kurali Bypass Corridor & only a short drive away from Airport Road.

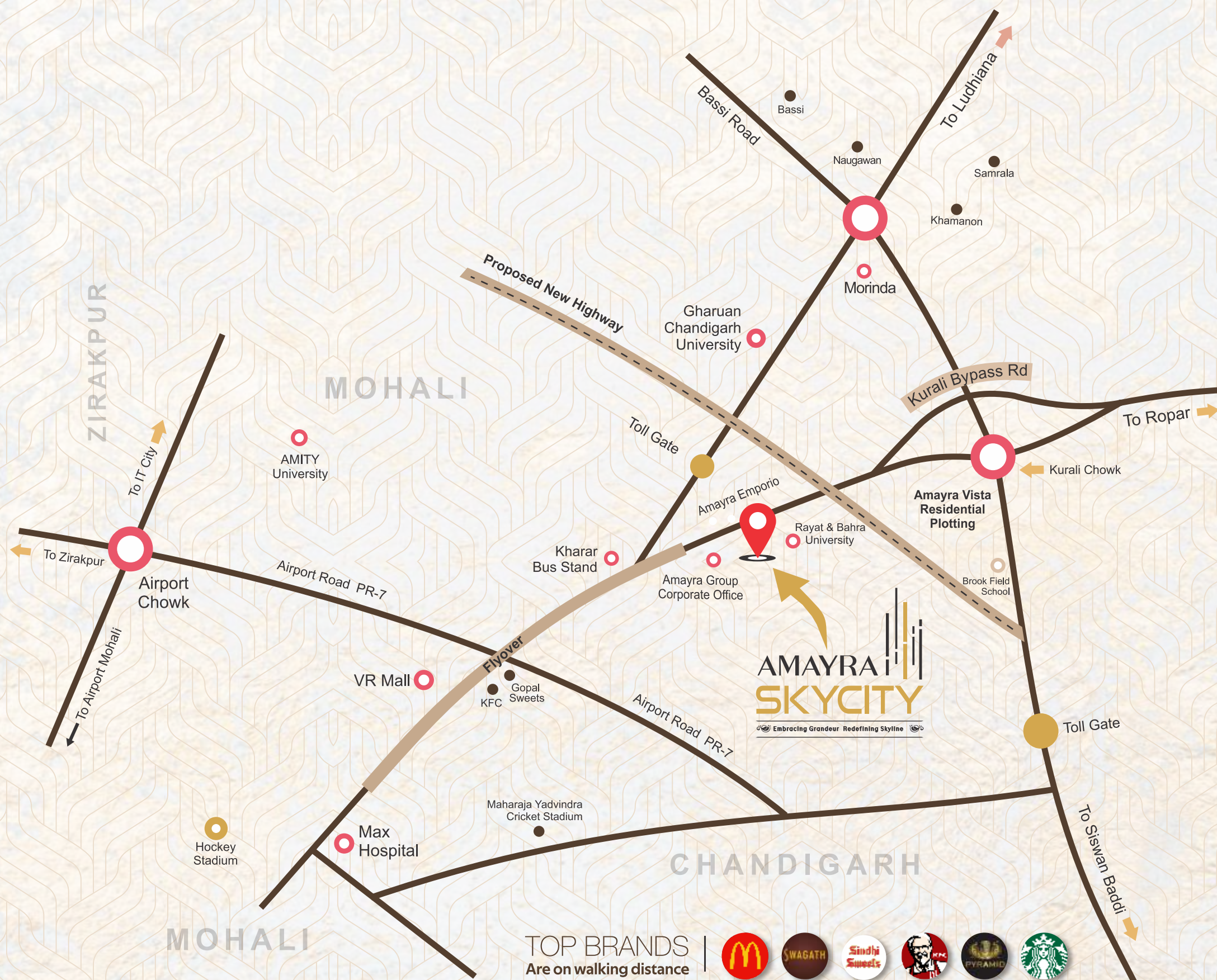

TOP BRANDS  
Are on walking distance



## AN IDEAL LOCATION

Artist's Impression

Disclaimer- This advertisement does not constitute an offer and/or acceptance and/or contract and/or agreement and/or transaction and/or any intention thereof and/or a disclosure under any statute of any nature whatsoever. The photograph contained herein has been modified, and/or enhanced, and/or touched up/airbrushed for display and marketing purposes. No representation or warranty is made or intended as to the accuracy or completeness of information under this advertisement/promotional document or as to its suitability or adequacy for any purpose. Before making a decision to purchase, you are requested to independently, either directly or through your legal/financial consultants, thoroughly verify all details/documents pertaining to this project as available on <https://punjab.rera.gov.in>

A RERA Registration No. PBRERA-SAS80-PR1219  
View details at <https://punjab.rera.gov.in>



College & UNIVERSITIES



Multi speciality HOSPITALS



Reputed SCHOOLS



Hypermarket & MALLS



### FUTURE PERFECT, FOR YOU AND FOR THE FAMILY.

Amayra SkyCity is a vibrant, centrally located community that caters to your growing needs, the Airport, IT Parks, Malls, Schools, Educational Institutions, Hotels and Hospitals are in nearby within a 10 km radius. Historically, the best locations in the world are developed around a vicinity due to easy connectivity, upmarket lifestyle and a unique mix of commercial and residential development.

# AN UNFORGETTABLE ARRIVAL TO EXPERIENCE THE GRANDEUR

AN ICONIC ENTRANCE FOR LASTING IMPRESSION FOR YOUR ARRIVAL

Homes at Amayra SkyCity have been created for those who do not compromise on the quality of life. The human need to stay close to nature has been satisfied through architectural design, without compromising on safety, security, the comforts of a great home and all the amenities of luxury.



Beautiful Arrival Driveway



Grand Drop-off Zones

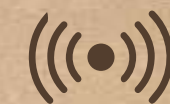

RFID Tagged Entry System



Business Centre



## ICONIC FACADE ENTRANCE

Artist's Impression

Disclaimer- This advertisement does not constitute an offer and/or acceptance and/or contract and/or agreement and/or transaction and/or any intention thereof and/or a disclosure under any statute of any nature whatsoever. The photograph contained herein has been modified, and/or enhanced, and/or touched up/airbrushed for display and marketing purposes. No representation or warranty is made or intended as to the accuracy or completeness of information under this advertisement/promotional document or as to its suitability or adequacy for any purpose. Before making a decision to purchase, you are requested to independently, either directly or through your legal/financial consultants, thoroughly verify all details/documents pertaining to this project as available on <https://punjab.rera.gov.in>

A RERA Registration No. PBRERA-SAS80-PR1219  
View details at <https://punjab.rera.gov.in>

# MAJESTIC ENTRANCE LOBBIES TO WELCOME YOU HOME

A DOUBLE-HEIGHT ENTRANCE LOBBY CONTEMPORARY-DESIGN MULTI-STOREYED TOWERS

Thoughtfully-crafted and uniquely-designed towers welcome you every time you enter the gate. Walk into grand entrance lobbies that are tastefully furnished and have top-of-the-line interior decor to give you a red-carpet welcome, befitting the kind of reception you deserve.



Grand Entrance Lobby



Lavish Interiors



High Speed Elevators



Wifi Enabled Lobbies



## EXCLUSIVE WAITING LOUNGE

Artist's Impression

# EXCLUSIVITY IS A FEELING YOU WILL GET USED TO

ENVELOPED IN PEACE. COCOONED IN LUXURY. DESIGNED FOR COMPLETE LIFESTYLES

The entire pool area has been designed as a sort of secluded alcove enveloped in tropical plants landscaped to surround the pool and you. Giving you that feeling of privacy you want to rejuvenate yourself. Within this lie the infinity pool, the kids' pool and the pool side deck – each designed to give residents the peace that is so needed in a stressful world.



Swimming Pools



Spa



Jacuzzi



Kids' Play Area



## ROOFTOP LAVISH POOL

Artist's Impression

# ACHIEVING YOUR FITNESS GOALS IS NOW EASY

NEW-AGE FITNESS ROUTINES. FOR A NEW-AGE LIFESTYLE

Remember that new year resolution you made? It's time to stick to it at the fully equipped gym. You'll find all the latest machines, from treadmills to ab-works to crossfit equipment to gym stations – everything you need for cardio as well as strength training. Work everything out for all you're worth. And when you need to bring your racing heart down to normal, there's always the yoga room to calm down in.



2 Level Gymnasium



Yoga/Aerobics Room



Open Badminton Court



Half-Basketball Court



## MODERN HI-TECH GYM

Artist's Impression

# YOUR SOCIAL NETWORK, AMIDST A LAVISH LIFESTYLE

COMING TOGETHER TO CELEBRATE SPECIAL OCCASIONS FOR YOUR SOCIALIZING NEEDS

Besides beautifully designed residential apartments, Amayra SkyCity offers a host of amenities and services like a gym, library, restaurant, and much more, at the resident exclusive clubhouses for each condominium. Perfect places for you to spend time with your neighbours and let your hair down and relax with friends. Catering to the everyday health and wellness needs of residents are additional recreational facilities like swimming pools, tennis courts, kids play areas and a basketball court, among others.



Party Hall



Billiards/Pool Room



Table Tennis



Library



## CLASSIC ELEGANCE RESTO BAR

Artist's Impression



BASKETBALL COURT



KIDS PLAY AREA



BADMINTON COURT



RECREATIONAL AREA



# ACTIVITIES THAT KEEP YOU HALE & HEARTY.

In a city that's constantly growing and always on the move, it's rare to find a place that puts you at the heart of it all. And yet, offers a space away from all the hustle and bustle. Amayra SkyCity is one such place. Where the kids can run free and where laughter fills every space and new memories fill every corner. Amayra SkyCity offers you a chance to indulge your athletic side with courts for every sport. Enjoy the open-air as you challenge your neighbour to a match up. Or as you teach your kids the basics. Whatever you're playing, you'll find enough activity to keep you going every evening.

# WHERE THE POSH AND THE PERSONAL MEET UNFORGETTABLE

ENJOY THE WARMTH AND COMFORT OF LUXURIOUS SPACES

Personal spaces are important in today's world, so privacy is built into the very design of the towers. None of the residences within the building face each other; they face outwards in a unique fan-shaped design. Not only that, the entrance to each residence is planned in such a way that they are not directly visible once one gets off from the elevators. These thoughtful touches ensure that all the residents can enjoy their own private world.



Efficient Planning



Spacious Layout



High Quality Fittings



Smart Electrical



## MASTER BEDROOM

Artist's Impression

Disclaimer: This advertisement does not constitute an offer and/or acceptance and/or contract and/or agreement and/or transaction and/or any intention thereof and/or a disclosure under any statute of any nature whatsoever. The photograph contained herein has been modified, and/or enhanced, and/or touched up/airbrushed for display and marketing purposes. No representation or warranty is made or intended as to the accuracy or completeness of information under this advertisement/promotional document or as to its suitability or adequacy for any purpose. Before making a decision to purchase, you are requested to independently, either directly or through your legal/financial consultants, thoroughly verify all details/documents pertaining to this project as available on <https://punjab.rera.gov.in>

A RERA Registration No. PBRERA-SAS80-PR1219  
View details at <https://punjab.rera.gov.in>

# TURN THE LEISURELY MOMENTS GATHER IN YOUR LIVING SPACE

ULTRA-LUXURIOUS HOMES THAT REDEFINE THE HEART OF FINE LIVING.

These amazingly-designed 2,3,3+1 BHK homes blend elegance with opulence. Habitable from the 5th floor onward, you can retreat from the hustle bustle of the city into your very own private zen replete with every luxury you could dream of. Raising the luxury benchmark of Mohali, Amayra SkyCity rises 22 floors above the city for views unlike any other.



Elegant Design



Large Windows



Premium Fittings



Marble flooring



## DRAWING & LIVING

Artist's Impression

# A STYLISH KITCHEN. AN ESSENTIAL INGREDIENT IN EVERY RECIPE.

AS DELIGHTFUL AS THE AROMAS IT INSPIRES.

A modern kitchen is not just about convenience, it's about style and personality. An evocative space that inspires, your kitchen is ideally crafted with intelligent design that helps bring your culinary skills to life. The polished granite platform makes your kitchen an exquisite space to be in, while the CNG/LPG leak detector ensures safety. Needless to say, with a kitchen so divine, the meals you prepare will truly be heavenly



Wifi Enabled Lobbies



Smart Home Automation



RFID Tagged Entry System



IP Video Door Phones



## MODULAR KITCHENETTE

Artist's Impression

Disclaimer- This advertisement does not constitute an offer and/or acceptance and/or contract and/or agreement and/or transaction and/or any intention thereof and/or a disclosure under any statute of any nature whatsoever. The photograph contained herein has been modified, and/or enhanced, and/or touched up/airbrushed for display and marketing purposes. No representation or warranty is made or intended as to the accuracy or completeness of information under this advertisement/promotional document or as to its suitability or adequacy for any purpose. Before making a decision to purchase, you are requested to independently, either directly or through your legal/financial consultants, thoroughly verify all details/documents pertaining to this project as available on <https://punjab.rera.gov.in>

A RERA Registration No. PBRERA-SAS80-PR1219  
View details at <https://punjab.rera.gov.in>

FLOOR PLANS

TYPICAL FLOOR PLAN



BLOCK

2 BHK SUPER AREA : 1369.04 Sq.Ft. & 1337 Sq.Ft.

- The pursuit of excellence -

# TYPICAL FLOOR PLAN

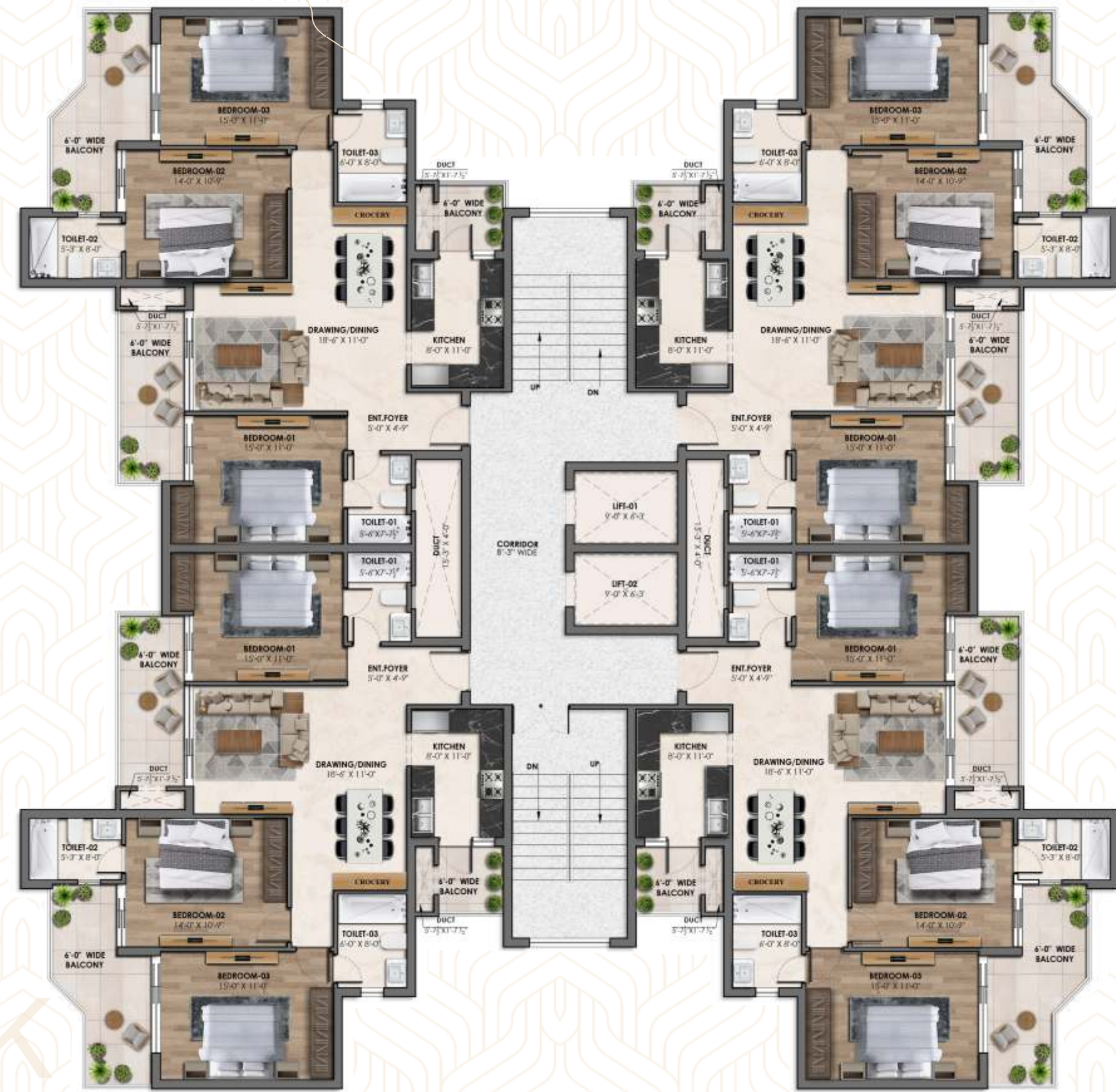

3 BHK SUPER AREA 1723.22 Sq. Ft.

- The pursuit of excellence -

# TYPICAL FLOOR PLAN



3+1 BHK SUPER AREA 2270.72 Sq. Ft.

- The pursuit of excellence -

BLOCK

B

BLOCK

A

# TYPICAL FLOOR PLAN



LOWER PENT HOUSE | SUPER AREA : 2314.27 Sq. Ft.

- The pursuit of excellence -

# TYPICAL FLOOR PLAN



UPPER PENT HOUSE | SUPER AREA : 1534.22 Sq. Ft.

- The pursuit of excellence -

BLOCK

A

BLOCK

A